

# Sanctuary seating - standard arrangement

This is the arrangement addressed by the general fire risk assessment. Any other arrangement requires a fire risk assessment for that arrangement



It is required that, when seats are in rows, seats:

- a) Are provided with a clear space in front of them of at least 305mm (1 foot);
- b) No such chair is more than seven (including itself) chairs from a gangway of at least 1.05 metres (3 feet 6 inches) in width;
- c) Are connected in lengths of at least four (or the row length where shorter) and not more than twelve using the clips mounted on the chairs;

The above distances are not diminished below the figures given by projections into the aisles.

A standard wheelchair takes four chair spaces but may take two provided that it does not infringe the escape paths. Wheel chairs must not impede the exit from a row unless exit in the opposite direction is possible past six or fewer chairs.

- Emergency escape route (minimum width 1.05m) - must be kept clear
- Fire door - must be closed if fire in building except when people passing through it - should not be wedged
- Fire extinguisher (water) black spot = CO<sub>2</sub>
- Aid to chair layout

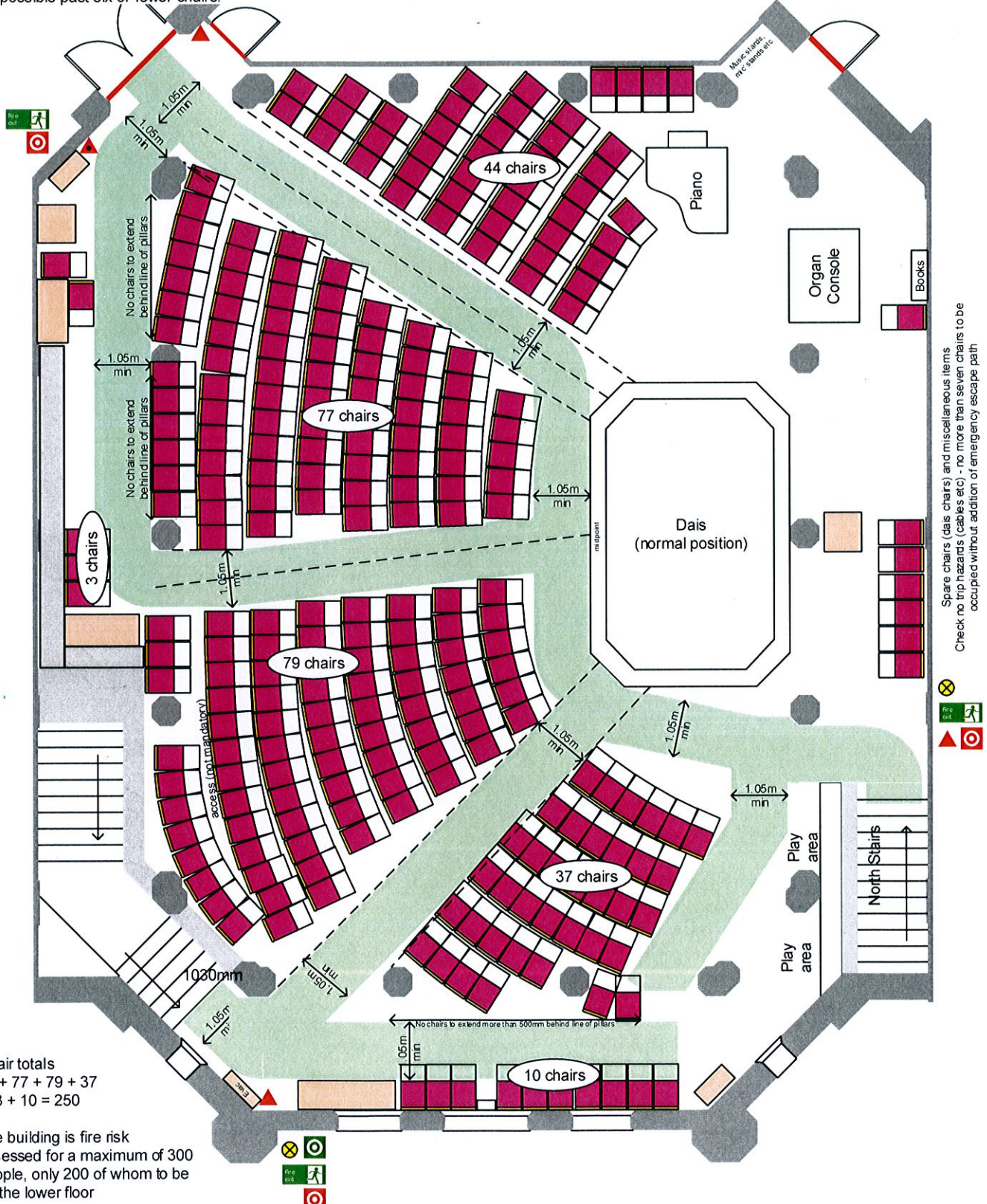

Chair totals  
 44 + 77 + 79 + 37  
 + 3 + 10 = 250

The building is fire risk assessed for a maximum of 300 people, only 200 of whom to be on the lower floor